

CommunityCare **live21**

BDC, London | 12-13 October

Event Partner



Essex County Council

Learning Sponsor



**Hampshire
County Council**

**Community
Care Live is back,
face to face,
for 2021!**

**Exhibition and
Sponsorship
Opportunities**

communitycarelive.co.uk

The Community Care Group

Launched in London over 20 years ago, our annual flagship event, Community Care Live, is the UK's largest free to attend social work event. On offer is a free expert seminar programme providing essential learning and training for social work professionals, supported by an exhibition where visitors, exhibitors and speakers can meet, network and share learning with other organisations within the sector including local authorities, residential care providers, suppliers, recruiters, the voluntary sector and universities. In addition to the free seminar programme and exhibition we also offer a legal learning stream. These sessions offer the latest legal updates from some of the country's leading experts. A fee applies to reserve a place at these 8 sessions.

Community Care Live 2021

Due to the global pandemic in 2020 we were unable to host Community Care Live in person, but, determined to continue to deliver the same opportunities to the sector, we took the whole event online to deliver Community Care Virtually Live, which was a great success and well received by the social work audience.

After such an uncertain year, the remarkable work by all involved in the vaccine programme and the current roadmap have brought a very positive, and much welcomed, outlook for the rest of this year and beyond.

Due to this positive progress we are delighted to announce our return to a face to face event at the Business Design Centre in October 2021.

We look forward to building on the success of Community Care Virtually Live in 2020, as well as all the Community Care Live events over the years, and we very much look forward to welcoming you back.

**“Very
informative and
reignites my
passion for the job.”**

Social Worker,
Wiltshire Council

For more information contact:



Nicola Davies



nicola.davies@markallengroup.com



07787 151949

Why Exhibit?

Community Care Live provides the opportunity for your organisation to engage with a professional and highly engaged social work audience including team managers, heads of service, directors, principal social workers, senior practitioners, social workers, local authority commissioners and workforce leads. While we have all had to adjust to a year of video calls and remote learning, there is no way to fully replicate the benefits of face to face interaction, learning and networking that this event provides.

Make sure your organisation is part of Community Care Live 2021 so you can:

- Be part of a key event in the social work calendar
- Network with key decision makers including commissioners, directors and team managers
- Meet with an audience of highly engaged social work professionals
- Take advantage of face to face interaction within the social work sector at this essential learning event
- Position your organisation as a supporter of social work training, learning and career development
- Discuss any career opportunities directly with active and potential jobseekers whilst positioning your organisation as an employer of choice

Who's at the event?

- Over 1600 social work professionals attended Community Care Live 2019, with almost 5000 attending the virtual event in 2020
- Around 20% of attendees hold senior titles including commissioners, heads of department, workforce leads, principal social workers and team managers
- At the 2019 event, 56% of attendees were from local authorities, with over 100 different local authorities represented. For the 2020 virtual event local authority participants accounted for almost 70% of attendees
- A wide selection of organisations supported Community Care Live 2019 including local authorities, charities, independent sector providers, social care suppliers, universities, NHS trusts, book publishers and consultancies
- In 2019 97% of attendees said they would recommend Community Care Live to others, while last year 95% said they would recommend the virtual event

“ I learnt so much to take back to my team.”

Senior Social Care Assistant,
Surrey County Council

“ Creative, innovative, energising – a great networking opportunity.”

Social Care Policy and Practice Support Manager, NICE

For more information contact:



Nicola Davies



nicola.davies@markallengroup.com



07787 151949

What does Community Care Live offer visitors?

Every year social work professionals choose to take the time out of their busy schedules and join us at Community Care Live to:

- Attend the exhibition – make sure your organisation is there to meet and speak to attendees about your exciting plans and developments
- Seek new career and professional opportunities – if you're looking for the best employees or have further training and courses to offer, don't miss out on the chance to discuss these directly with potential candidates
- Learn from the informative sessions, master classes and debates, and listen to engaging speakers
- Join colleagues from the social work community as they come together from across the country all under one roof
- Contribute towards professional development – demonstrate how your organisation is committed to helping those in the sector reach their potential

“Engaging
information to expand
your knowledge.”

Senior Social Worker,
Derby County
Council

For more information contact:



Nicola Davies



nicola.davies@markallengroup.com



07787 151949

How do I exhibit?

Community Care Live offers a wide range of options for your organisation, to suit both your budget and objectives. Packages range from full event sponsorship to single exhibition stands and everything in between. Our team will work with you, and give you the platform, to ensure your organisation's objectives are met. Exhibition spaces are limited so contact the team as soon as possible to discuss how the event can work best for you.

Example shell scheme stands and prices

2m x 2m shell scheme stand from **£2,500 + VAT**

3m x 2m shell scheme stand from **£3,400 + VAT**

3m x 3m shell scheme stand from **£4,050 + VAT**

6m x 3m shell scheme stand from **£7,200 + VAT**

Included:

All shell scheme stands will include fascia and name board with exhibitor name and stand number, 1 x 5' fluorescent light tube per stand, carpeted floor, and 50-word profile on the event website and in the event guide.

N.B. Special discounted rates apply for registered charities, universities and book publishers – please get in touch for further details.

Recruitment consultancies please call for ratecard.



“Well organised seminars, very informative, a good networking experience.”

Social Worker/Team Manager, Bristol City Council

For more information contact:



Nicola Davies



nicola.davies@markallengroup.com



07787 151949

Enhance your presence at the event

There are a number of sponsorship and promotional opportunities available at Community Care Live 2021, including event guide advertising, seat drops, speaker opportunities, event host and sponsor packages. These provide an unrivalled opportunity to maximise your presence at the event ensuring your organisation is front of mind for all visitors to Community Care Live. Find out more below, and contact Nicola Davies, Senior Partnership and Event Manager, who would be delighted to discuss these opportunities with you.

PRE-EVENT



Branding on communitycare.co.uk

Let our audience know you'll be at the event by taking advantage of discounted rates for online adverts on communitycare.co.uk when you sign up for an exhibition stand.

Price on application.

DURING THE EVENT



Event guide

The event guide (printed version) is given to all attendees for them to read and refer to both during and after the event. Placing an advert in the event guide is a simple but effective way of delivering and reinforcing a message to this engaged audience and encouraging visits to your stand. The guide will also be available online during the event.

Prices start from £950 + VAT.



Sponsored speaker opportunity

A perfect opportunity for your organisation to position itself as a thought leader through hosting your very own one hour workshop, which will be integrated into the main seminar programme. Our producer will discuss the subject and content with you to ensure that it meets our educational learning criteria and maximises attendance.

Price on application.



Seat drop

If you have a key message you want to communicate to a specific group of people, a seat drop allows you to target those interested in certain session topics.

Prices start from £300 + VAT

“**Inspirational!**”

Workforce Development
Officer, Leeds County Council

“**Great conference
as always with lots
of fantastic learning
opportunities and
networking.”**

Deputy Lead
Safeguarding Officer,
IICSA

For more information contact:



Nicola Davies



nicola.davies@markallengroup.com



07787 151949

Community Care Live 2021 Floor Plan

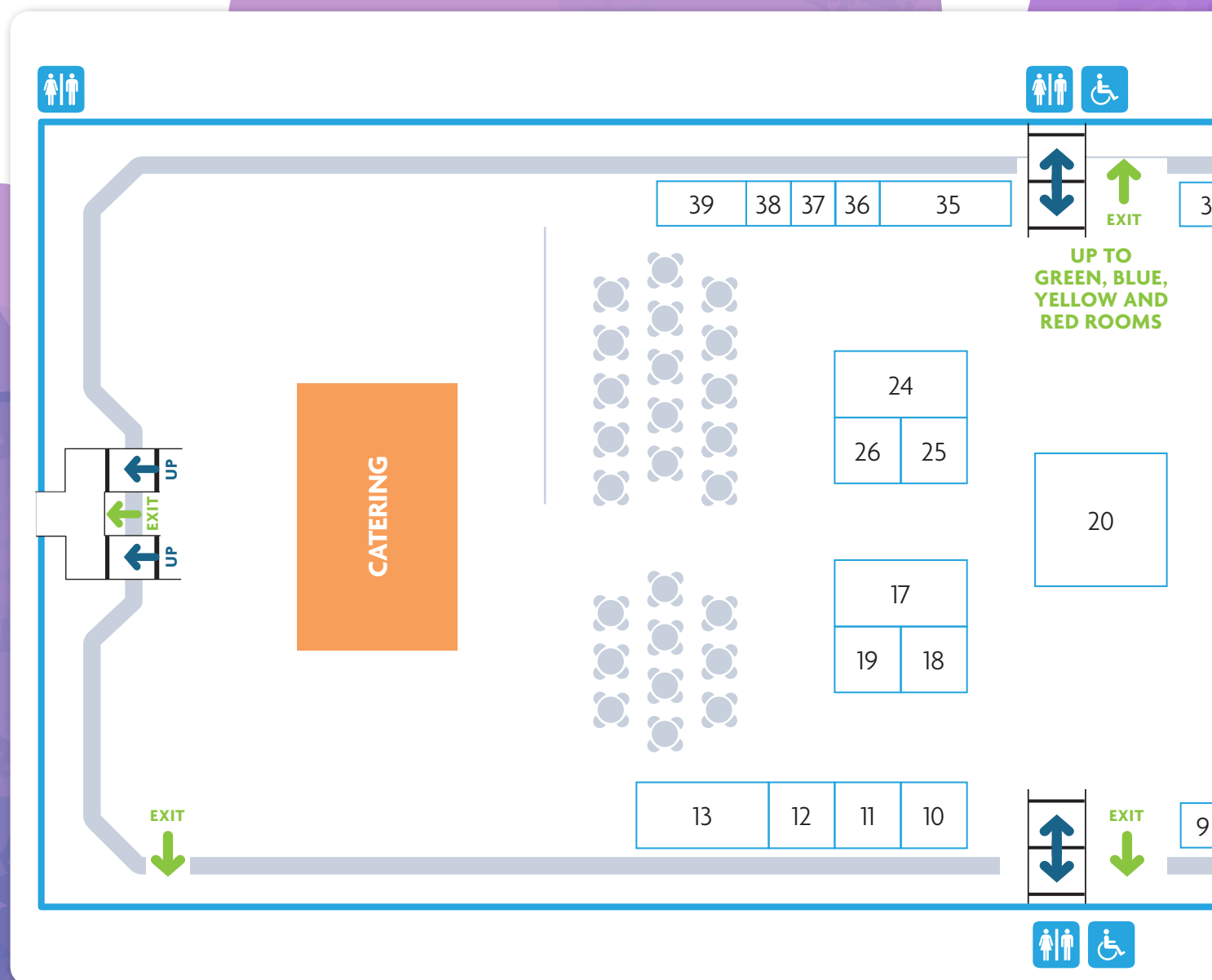

For more information contact:



© Nicola Davies



 nicola.davies@markallengroup.com



 07787 151949

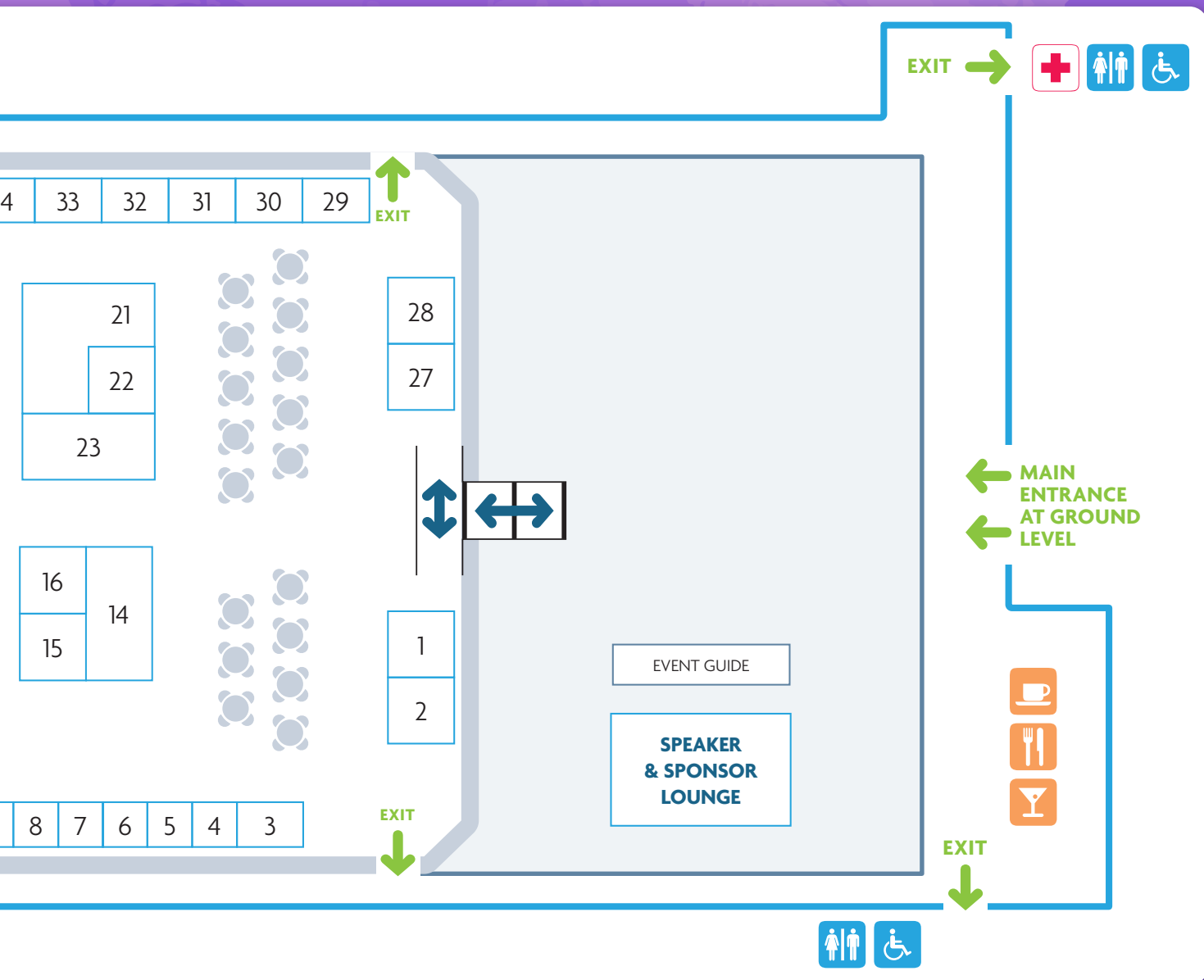

CommunityCare live21

BDC, London | 12-13 October

Thank you to our Event partner and Learning sponsor:



Essex County Council



Hampshire
County Council

communitycarelive.co.uk